

# BISMAT® 5000

for plastic pipes 16 - 50 mm

M8

(A 25 05)

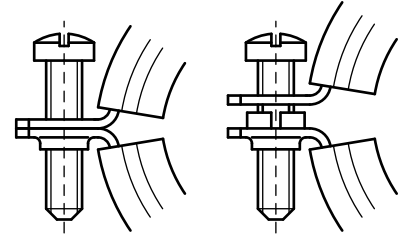

## Features and Benefits

- single screw clamp
- with BISMAT® quick locking system
- removable spacer washers allow the sliding or gripping of the pipe within the clamp
- suitable for plastic pipe
- material: steel
- zinc plated
- noise insulating lining, EPDM rubber, green
- lining: very suitable for applications with plastic pipes
- inner part of lining is flush to improve sliding of pipe in clamp
- age resistant lining
- sound insulating lining according DIN 4109



RAL-GZ 655/B  
Cert.Nr. 2010-24

Part No.	D (mm)	G	B (mm)	H (mm)	h (mm)	b x s (mm)	F <sub>a,z</sub> (N)	RAL	Pack 1
3483018	16	M8	48	40	22	20 x 1.00	350	RAL <sup>1</sup>	50
3483023	20	M8	55	43	23	20 x 1.00	350	RAL <sup>1</sup>	50
3483028	25	M8	60	48	26	20 x 1.00	350	RAL <sup>1</sup>	50
3483035	32	M8	67	57	30	20 x 1.00	350	RAL <sup>1</sup>	50
3483043	40	M8	75	66	34	20 x 1.25	420	RAL <sup>1</sup>	50
3483053	50	M8	85	75	37	20 x 1.25	420	RAL <sup>1</sup>	50

*RAL<sup>1</sup> = tested, certified and monitored by a third party according to RAL-GZ 655/B.  
For detailed technical information about our RAL marked products, please see the RAL datasheet in our web catalogue.*

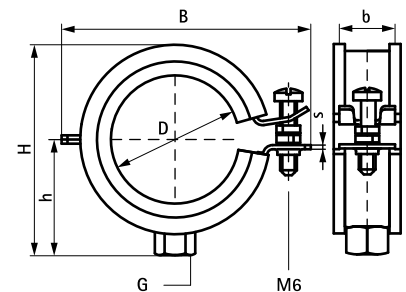

## Complementary

Walraven RapidRail® Fixing System  
Walraven Fastenings  
BIS Pipe Reinforcement